

ACCES IMOBIL



ACCES AP. 29

ACCES IMOBIL

Apus

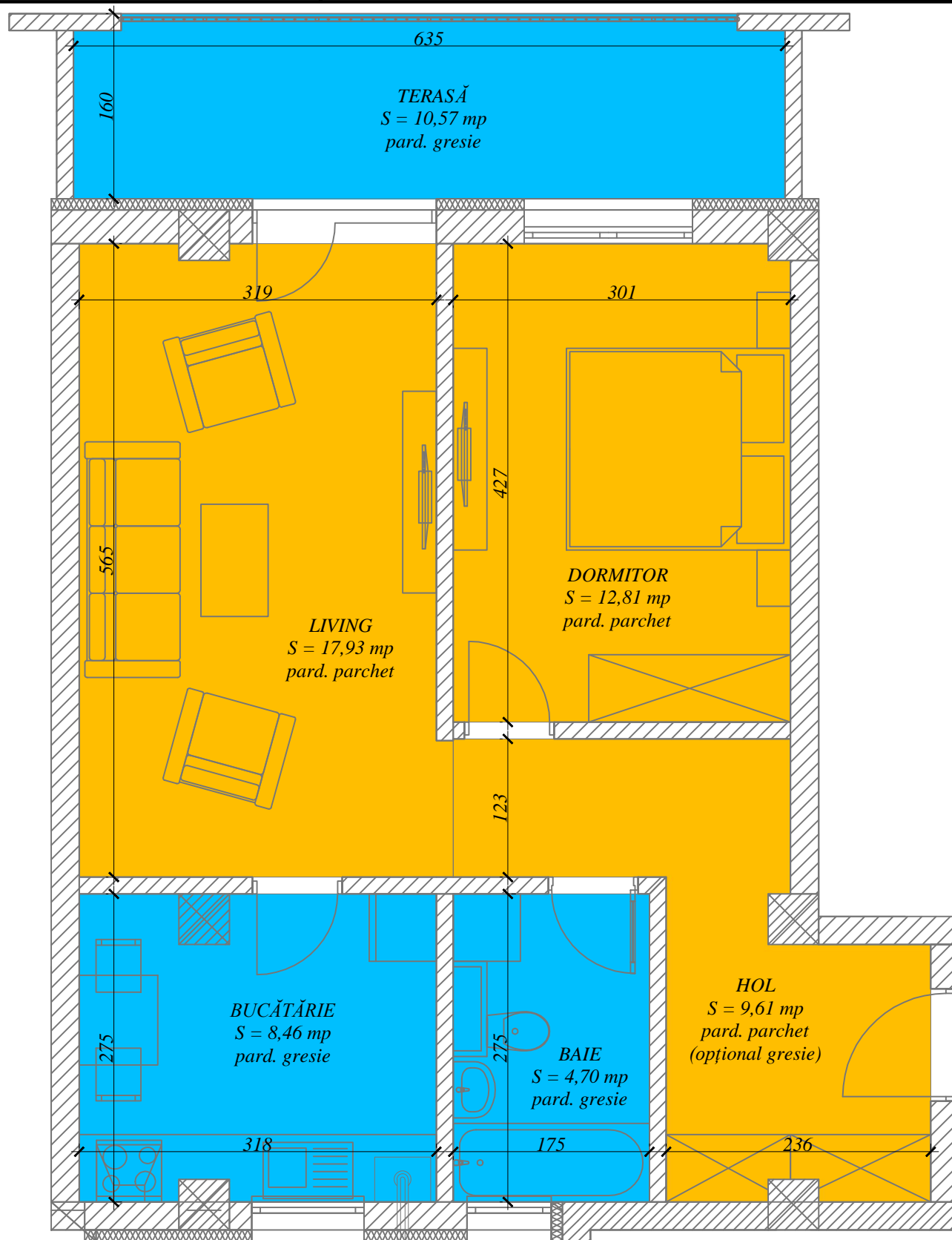
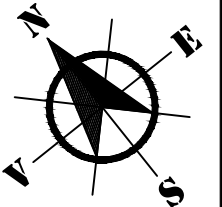

ACCES APARTAMENT

Plan AP. 29 imobil ELIZA 1, scara 1:50

Sconstruit Ap. 29 = 65,79 mp

Sbalcon Ap. 29 = 10,57 mp

Sutil Ap. 29 = 53,51 mp

Sutil + Sbalcon Ap. 29 = 64,08 mp